

TOP VIEW

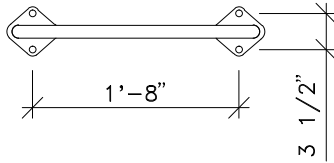

3'-0"
(915 mm)

0'-0"
FINISHED
GRADE

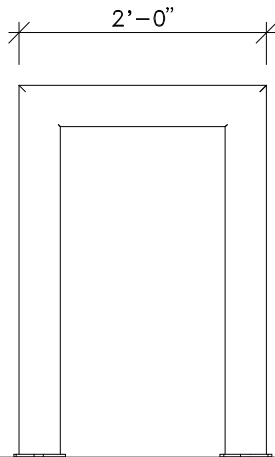

FRONT VIEW

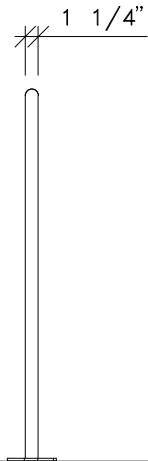

SIDE VIEW

CYCLOOPS

0'-0"
FINISHED GRADE

-(0'-10")
-(254 mm)

NOTE:
CONCRETE FOOTING AND NO. 4
REBAR (BY OTHERS) PER LOCAL
SOIL CONDITIONS. CONSULT
PROJECT ENGINEER FOR EXACT
REQUIREMENTS.

2178-87-E (EMBEDMENT)

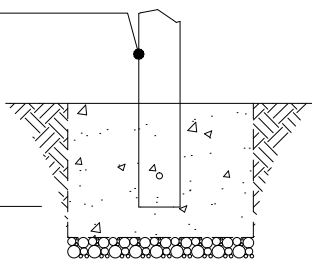

CYCLOOPS

5/8" (16 mm) DIAMETER
HOLES PROVIDED FOR
ANCHORS BY OTHERS
(TYPICAL-4)

2178-87-SM (SURFACE MOUNT)



This drawing reveals the copyrighted intellectual property of Columbia Cascade Company. Not for use by others without our express, written authorization.
Authorization for use is hereby granted to architects, landscape architects and similar design professionals solely for the purpose of specifying TimberForm products.



COLUMBIA CASCADE COMPANY
Makers of TimberForm®, PipeLine®,
RePlay®, TimberForm®-2, InterPlay®,
CyclLoops® and CycLocker® Products.

1300 S.W. Sixth Avenue, Suite 310 Telephone 503/223-1157
Portland, Oregon 97201-3464 Facsimile 503/223-4530
U.S.A.

WWW.TIMBERFORM.COM

Title:
TIMBERFORM
MODEL NO. 2178-87
CYCLOOPS PORT



Scale
3/4" = 1'-0"

Drawn by: CL 10-25-11
Ck'd by:

Drawing No.
W-2178-87

Sheet
1 of 1